

Pneumatic Capping Machine MOD C

St. Patrick's of Texas•1828 Fleischer Drive•Austin•Texas•78727

www.stpats.com

512-989-9727

No part of this document may be reproduced in whole or part, by photocopy or any other means, without prior written permission from St. Patrick's of Texas.



WARNING!

Read This First

Disconnect air compressor before doing any regulation on the machine!

Failure to do this may result in damage to the machine itself and could create danger.

Always keep face and any uncovered part of your body behind protections!

Failure to do this may result in harm to the operator. At the purpose it is recommended to use protective glasses, gloves and clothes.

Never use damaged / chipped bottles!

Failure in doing this might result in the bottle to collapse or even explode, creating danger to the operator.

Clean and lubricate the moving parts of the machine!

Disconnect compressed air after use!

Failure to do this may result in corrosion or early wear of parts therefore enhancing probability of future malfunction. Refer to this manual for correct use, the web site and your dealer for further advice.

Table of Contents

Quick Start	3
Machine setup	3
Choose the Cap	4
Machine operation	5
Technical details	6

Quick Start

Model C capping machine allows you to cap the most used bottles with crown caps.

Model C does not require difficult regulations. Nevertheless, in order to operate, it requires a source of compressed air.

For further details, please read through this manual.

To operate the machine you will need to:

1. Place the cap under the collar (a magnet will hold it afterwards)
2. Position the bottle on the base placing it in line with the collar
3. Position both hands over the two pneumatic valves
4. Press both valves while keeping your face behind protection until correct cap insertion
5. Release pneumatic valves and remove the capped bottle

Machine setup

Model C is shipped with a bottle placer (the dish in Figure 1) and a spacer (pipe). Use the spacer only if your bottle is less than 30cm.

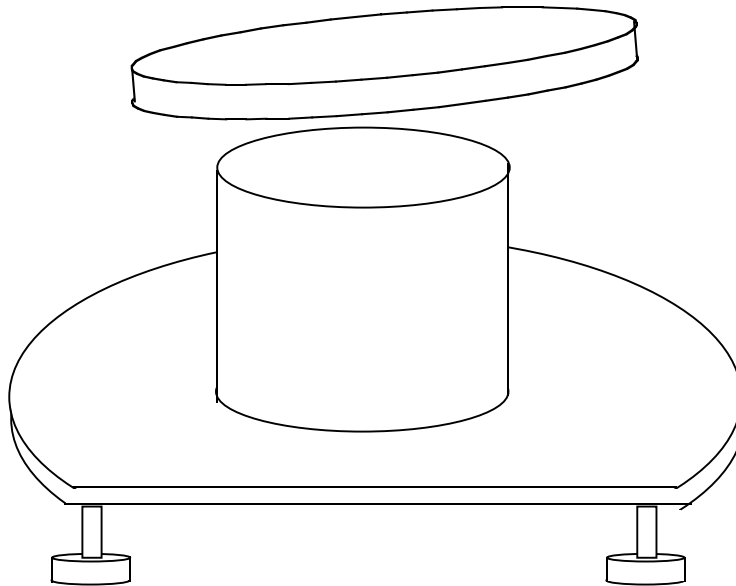

Figure 1

Air compressor minimum capacity is 15 liters. The pressure must be regulated between 3 and 6 bar [45-90 psi] (accordingly to your cap's stiffness and bottle's strenght).

ATTENTION: Alway control air pressure. Excessive air pressure may result into a damaged bottle. Always test your bottle's strenght prior to any capping operation and never exceed the maximum operating pressure of 6 bar [90 psi].

Connect to the air compressor through a 1/8 bayonet connector as shown in Figure 5.

Choose the right collar

Always employ the collar matching your cap dimensions. Shipped collars are named "A" e "B" as shown in Figure 2.

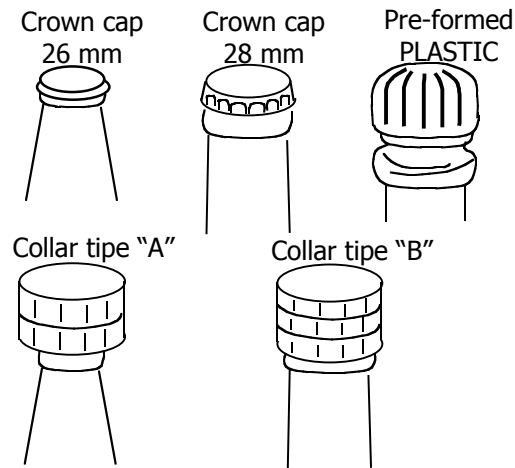

Figure 2

Assemble the capping device as shown in Figure 3, by inserting the magnet (3) into the collar (4), followed by the spring (2) and the bolt (1).

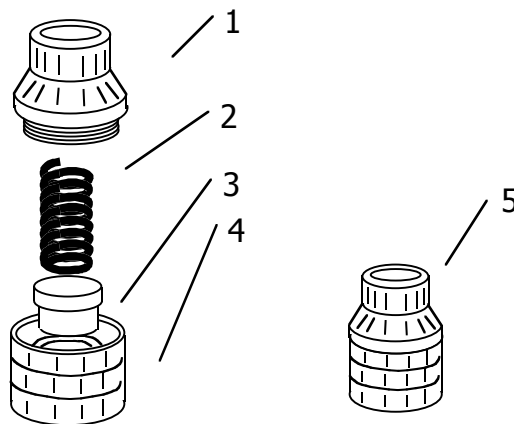

Figure 3

Connect the device to the punch as shown in Figure 4.

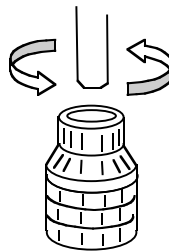

Figure 4

Machine operation

1. Connect air compressor as shown in Figure 5.

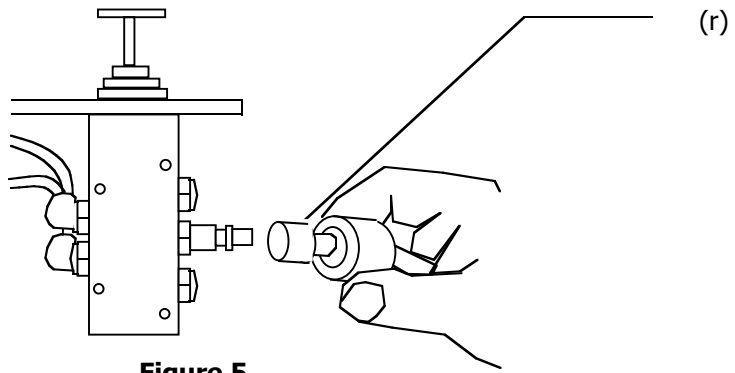

Figure 5

2. Place your cap (*n*) under the collar (*m*), as shown in Figure 6: the magnet will hold it.

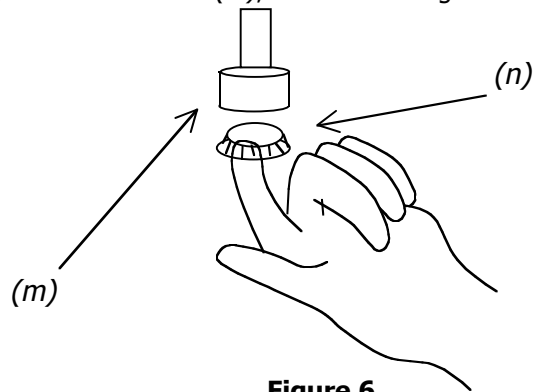

Figure 6

3. Place the bottle in line with the collar as shown in Figure 7.



Figure 7

4. Place both hands on the pneumatic valves.

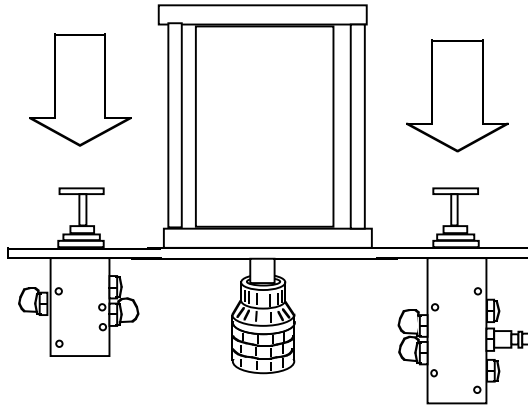

Figure 8

5. Press both button until the bottle is capped correctly .

ATTENTION: Always protect yourself when operating the machine and handling bottles by employing protective glasses, gloves and cloths.

6. Release both buttons and remove capped bottle.

Technical details

The machine:

- **Weight:** ~10Kg
- **Width x Depth x Height:** 28 x 16 x 70cm
- **Use:** to place on a ~80cm height bench. Use while standing
- **Performance**
 - 400 bottles / hour max
 - 4 000 – 10 000 bottles / year max recommended
- **Noise:** less than 70dB

The Bottles:

- **Height**
 - 24 – 38 cm (9 _ – 15 inches)
- **Caps**
 - "A" – crown 26mm [Standard caps in US]
 - "B" – crown 28mm and plastic pre-formed